



## PRESIDENT'S REPORT

### **PRESIDENTS REPORT - AGM:**

To All Members of the BRWG,

Another year has gone and the "Woodies" at Montville are now 21 years old.

You may remember the "think-tank" meeting we held in 2015 to create a development Plan for 2016 - 2017 and Beyond. This meeting allowed all members a voice in putting forward ideas and their aspirations for the BRWG into the future and from that meeting, the Development Plan was documented.

Throughout the time since, the Management Committee has deliberately set goals to meet the member's expectations as outlined in the plan. The most important of course has been the need to provide members with additional space as the number one objective was:

"Re-organize existing workshop space by incorporating more workable layout."

To do this, a new building had to be planned to provide the space to re-organize existing workshop space. During the past year, we have encountered some very real "road-blocks" to this process and I can now report those road-blocks are still with us. Essentially, the entrance to the Sports Field is not considered safe by the TMR and will not allow any further building on the site. This is still a work in progress and the outgoing management committee and the MVA are working to resolve the situation.

Towards the project, we were successful in achieving a grant from the Sunshine Coast Regional Council which will cover the slab for a new shed. We did apply for a grant from the Gambling Fund to complete the structure but missed out. The good news is we have successfully been gifted an Army building, one of those used in the Vietnam war so one could say we have now most of the ducks lined up; just need to get over the TMR issue.

Our community activities this year, apart for our expos and Santa shop, were:

- Australia Day celebrations at the Maleny Show Grounds
- Maleny Wood Expo
- Maleny Wood Expo Children's Workshop.
- and various community projects.

Another achievement this year has been the acquisition of some new equipment with the 8" jointed being replaced by a Hammer 300mm (under/over) jointer thicknesser combination machine, and a new Hammer Bandsaw. The Management Committee has adopted the policy in the plan to improve the equipment for all members.

As in the past, the Club still attracts many donations of salvaged logs and the milling, drying and handling methods have improved this year thanks to the dedication of the Timber Management team. The quality of sawn dry product available to members is much improved.

I wish to thank all the members of our management team for their efforts in the past year. The new shed has taken a lot of time and energy over the past year so hopefully next year, the next Management Committee will be able to report a more encouraging outcome.

John Henderson, our Vice President, has resigned recently due to ill health. We will miss the Sergeant-Major and wish him and Maria our very best.

Of course no President's report would be complete without acknowledging the tremendous contribution to the Club from Ray Curry, a foundation member, who passed away this year. A great loss to the Club, his mates and his family. RIP Ray!

Thanks to all the BRWG family for 2016/17.

John Muller  
President.

**From the Editor**

**You can see the Office Holders for 2017/18 in "Who's Who" further down. Remember, we are a Guild run by volunteers, so please contribute when you can.**



A Division of Trafalgar Projects Pty. Ltd. ACN 008 502 663

Unit 1, 34 Page St., Kunda Park, Qld 4556  
**Tel 5445 2189**  
Fax 5445 6392  
E. [admin@thestaircompany.com.au](mailto:admin@thestaircompany.com.au)  
Post P.O. Box 5332 Maroochydore BC 4558

## Maintenance Report *by Greg McCosker*



As our membership grows, so does the demand on equipment in the shed. The Guild has purchased two new pieces of Hammer equipment, which is light industrial but more robust than equipment held to date, in the expectation less maintenance will be required. Please ensure you respect the equipment when using it.

The Management Committee has determined that Members are not to use the new equipment until accredited. The original equipment remains in service and therefore available until members wishing to use the new equipment are accredited.

The Sherwood drop saw has been withdrawn from service, which leaves the sliding compound mitre saw for cutting small pieces of dressed, dimensioned timber. It is a saw for fine cutting, and is not intended for cutting rough, twisted, large pieces of timber in preparation for dressing.

The safety guard on the Bosch mitre saw was totally smashed in recent times. Whilst the circumstances are unknown, such damage suggests inappropriate use of the saw. Expensive repairs are now required, and the saw has been swapped out for the Makita.

For cutting large pieces of rough timber, a heavy duty, pneumatically operated docking saw has been installed, but is yet to be commissioned as we wait for the electrician. In the interim, if you have to cut rough timber, please do so with a hand-held power saw, and enlist the assistance of another member to do so safely.

### ALL ABRASIVES

INDUSTRIAL ABRASIVES SUPPLIER



Phone: (07) 5443 9211  
Phone: (07) 5443 9527  
Mobile: 0413 945 798  
Fax: (07) 5443 5714  
4/20 Kayleigh Drive  
Maroochydore Qld 4558

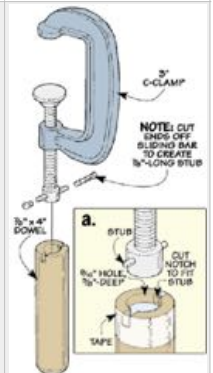

I often use a C-clamp when gluing up but sometimes the sliding bar used to tighten the clamp gets in the way. Before each turn, I have to slide the bar all the way to the opposite side. It's a pain.

To solve the problem, I cut both ends off the sliding bar and attached a wood handle to the remaining "stub." I can tighten the clamp now with a few quick turns (See photo).

As shown in the drawing, the handle is just a dowel with a hole drilled in the end to accept the head of the threaded screw. I also cut a notch in the handle to fit the stub.

After shaping the handle for a comfortable grip, a bit of epoxy is all that's needed to secure it to the clamp. But first, wrap the handle with tape to keep the epoxy from leaking.

With thanks to Woodsmith etips

w



**24 hour Fast Glass Replacement**

Mobile: 0427 943 733  
Phone: 5494 3733 Fax: 5494 3473  
6 Lawyer Street, Maleny



This month I will run through a few of the most used tools and machines.

**SANDERS.** Hand sanders are notorious for surrounding the operator in a cloud of dust. If you are not using the Mirca with vacuum, be sure to wear a mask. The finest particles that can float in the air for up to two hours are the worst, as they get down into the finest pockets of the lungs and stay there waiting for a problem which may develop years later. The linishers and other sanding machines are also offenders. You should have a good respirator in a tool box you bring to every session.

**ROUTING TABLES.** Keep your fingers away from the cutter. Never try to shape a bit of wood by presenting it between the cutter and the fence; be aware of the direction of rotation, between the cutter and the fence as the cutter could fire the piece like a bullet from a gun. Always use a push stick. If the shed push sticks are too cumbersome **make one!** It will take only a few minutes to notch a thin stick on the bandsaw.

**JOINTER.** Use a push stick on boards thinner than 50mm and avoid taking cuts deeper than necessary. **Do not alter the out feed table!** A friend in his shed two weeks ago did not notice that someone had lowered the out feed table. He pushed a bit of wood through, and toward the end it dropped, caught the cutters and unfortunately two fingers. He lost the end of one and the other was badly cut. Any machine will bite you if not used properly.

**GRINDERS.** Mind your eyes! We always recommend keeping your tools sharp (a blunt tool is a dangerous tool!) It is foolish in the extreme to start grinding without eye protection. Reading glasses only have not proved safe when fragments of hot steel fly.

**THICKNESSERS.** Pieces of wood too short to be covered by both rollers have been ejected violently. If this does not damage you it could stall and damage the thicknesser. I have seen the drum sander do this also. Seek advice from the shed captain if you are in any doubt.

**It is against club rules to use any machine unless you have been accredited.**

## Around the Shed



Well, great excitement this week, as we received our crated 1968 model Vietnam shed, which has been very generously gifted to us by the Australian Defence Force. Now, to the simple task of erecting it. It is just a big garden shed after all ! No doubt there will be many working bees in coming months.

We have viewed two identical sheds which have been erected, and a mighty fine shed they are. No doubt those who served our nation in Vietnam will recall the style. We are now working on planning the configuration of the new shed, and re-configuring the existing shed to achieve the best usable space.

So, while thinking of all things military, it may be timely to hear some pearls from Military Staff undertaking annual staff appraisals :

- 1. His men would follow him anywhere but only out of curiosity.*
- 2. I would not breed from this Officer.*
- 3. This man is depriving a village somewhere of its idiot.*
- 4. This Officer can be likened to a small puppy - he runs around excitedly, leaving little messes for other people to clean up.*
- 5. This Officer is really not so much of a has-been, more of a definitely won't-be.*

## Club Events Calendar



The Guild Christmas Dinner is on **Friday 15 December 2017**, at Flaxton Gardens, so please save the date. Tickets are not yet available however if you want to book, Treasurer Brian will be happy to accomodate you.

## Timber Tales by Bruce Chapman

The rested timber from the kiln has now been added to the retail racks. We now have three bays of silky oak, two bays of white cedar and a small amount of Japanese maple.

Currently the kiln holds a pallet of Queensland Maple and a pallet of predominantly Liquid Amber. This will be unpacked next week but rested on the floor before it finds its way to the racks for sale.

Waiting to be milled are two very large Liquid Amber logs, some more silky oak and a lot of Quandong.

The last in the Central Australia Tree Series from President John. This is a 500 year old Red River Gum taken at Yunta.



A man has been charged with murder for killing a man with sandpaper. His defence was that he only intended to rough him up a bit.

A promotional banner for Timbecon. It features a background image of a person's hands working with wood. The banner includes the following text:

Extensive Range  
Top Overseas Brands\*

**10% OFF**  
For BRWG Members

ONLINE  
ORDERS  
Code BRWG10

**Timbecon**  
Everything to get wood working

timbecon.com.au

WA / 81 Cleland Rd, Canning Vale 6108  
VIC / 150/25 Neerim Road, Reservoir 3072  
T / 1300 888 946 E / sales@timbecon.com.au

\* Some products excluded  
\*\* Minimum order of \$10. Further conditions apply

Shed Captain Roster - September 2017											
Monday		Tuesday		Wednesday		Thursday		Friday		Saturday	
								1	John Muller	2	Warne Wilson
4	John Muller	5	Greg McCosker	6	AM Leigh Boynton Terry O'Connor	7	John Holland	8	Nigel Cundy	9	
11	Lionel Tilley	12	Tom Black	13	AM Rob Otto PM Keith Carter	14	Ian Colledge	15	Hamish B/wick	16	Keith Muirhead
18	Dave Banister	19	Bruce Chapman	20	AM Max Barrenger PM Warne Wilson	21	Ray Bryant	22	Dave Edmond	23	Graham Bradford
25	Brian Harris	26	Dave Southern	27	AM Ron Fishwick Terry O'connor	28	John Drewe	29	John Muller	30	Warne Wilson

Shed Captain Roster - October 2017											
Monday		Tuesday		Wednesday		Thursday		Friday		Saturday	
2	John Muller	3	Greg McCosker	4	AM Leigh Boynton	5	John Holland	6	Nigel Cundy	7	
					PM Keith Carter						
9	Lionel Tilley	10	Tom Black	11	AM Rob Otto	12	Ian Colledge	13	Hamish B/wick	14	Keith Muirhead
					PM Warne Wilson						
16	Brian Harris	17	Bruce Chapman	18	AM Max Barrenger	19	Ray Bryant	20	Dave Edmond	21	Graham Bradford
					Terry O'Connor						
23	John Muller	24	Dave Southern	25	AM Ron Fishwick	26	John Drewe	27	John Muller	28	Warne Wilson
					PM Keith Carter						
30	Lionel Tilley	31	Greg McCosker								

## Innovation Corner



A portable cutting tool used to make boards too short.



An electric sanding tool commonly used to convert minor touch-up jobs into major refinishing jobs.



A large stationary power tool commonly used to launch wood projectiles for testing wall integrity. Very effective for digit removal.



A large stationary power tool used primarily to cut large pieces into small pieces so they more readily fit in the scrap bin after you cut on the inside of the line instead of the outside.

## Did you know ?

Did you know that a male Lion can mate up to fifteen times per night, with multiple partners. The moral of the story; do not join Rotary !



Kenyan-born and New Zealand-based artist Gordon Pembridge has developed a lifelong bond with nature. This connection with Mother Earth is often the main source of inspiration for his impressive wooden vessels that incorporate elements of natural history and portray colourful local wildlife.

Pembridge obtains the majority of his timber from storm-felled trees, and shapes it with a lathe, but the real magic happens when he meticulously hand-carves incredibly detailed wildlife scenes with a high-speed engraver.

These often feature flora and fauna from his most beloved places - Africa and Oceania. Finally, Gordon forms fitting colour compositions and applies them with an airbrush.

## The Life and Times of ....

This month we conclude the story of Allan Heaton ...

SUBSEQUENT TO THE HOSPITALISATION, ALLAN WAS ADVISED TO TAKE A LONG HOLIDAY... 'GET ON A SHIP TO ENGLAND OR SOMEWHERE FAR AWAY AND GET YOUR LIFE BACK ON TRACK' WAS THE ADVICE. HE DID, AND BOARDED THE GOOD SHIP "SS ORONTES" ON IT'S FINAL VOYAGE TO TILBURY ON THE THAMES RIVER IN LONDON. THE SHIP LEFT SYDNEY HARBOUR AMONG THE BOXING DAY SAILING BOATS IN 1960. SIX LONG WEEKS LATER, AND FOR ALLAN, SEASICKNESS ALL THE WAY, ARRIVAL IN ENGLAND BROUGHT AN APPRECIATION THAT HE WAS A LONG WAY FROM INNISFAIL WITHOUT MUCH MONEY IN HIS POCKET.

HE SAT DOWN AND WROTE ABOUT BEING 'BROKE' FAR AWAY FROM HOME AND SOLD IT TO AN EDITOR OF A PUBLISHING GROUP WHICH PRODUCED A LINE OF HOUSE-MAGAZINES. THAT EDITOR SUBSEQUENTLY OFFERED HIM A JOB EDITING A MOTORING CLUB JOURNAL, 'GOOD MOTORING'. THE PUBLISHING GROUP EDITOR SUGGESTED ALLAN TAKE A COURSE OF STUDIES BASED ON JOURNALISM AT A LONDON TECH COLLEGE.

ALLAN BEGAN WRITING A NUMBER OF OTHER ARTICLES AND SHORT STUDIES SUCH AS A SERIES HE TITLED 'A STRANGER LOOKS AT POLAND'. A COLLECTION OF SHORT STORIES WAS TAKEN ON BY THE GROUP EDITOR.

ALLAN'S OTHER PUBLISHED MATERIAL INCLUDES A NUMBER OF TALES FOR CHILDREN, A MAKE-BELIEVE OF THE BEGINNING OF THE WORLD HOW A YOUNG ABORIGINE MAY SEE IT. A SERIES OF SHORT STORIES FOR CHILDREN WAS "HOITY TOITY AND THE MAGIC MUSHROOM". HIS COLLECTION OF VERSE BASED ON 'SEEREENA AND THE SINGING GOD' HEADS UP A COLLECTION STARTED WAY BACK WHEN A ROUSE ABOUT AT EURABBA.

WHILE WORKING AS THE EDITOR OF 'GOOD MOTORING', ALLAN WAS ACCEPTED INTO THE INTERNATIONAL GUILD OF MOTORING WRITERS. THROUGH THAT PRESTIGIOUS ORGANISATION HE WAS ABLE TO TEST DRIVE THE CARS OF INTERNATIONAL CAR MANUFACTURERS. HIS INVOLVEMENT WITH THAT BRANCH OF MOTORING WRITING PLUS A PART ROLE WITH THE FAMOUS EARLS COURT MOTORING EXHIBITION, LEAD TO HIM ADOPTING FULL-TIME FREELANCE WRITING. THIS ENABLED HIM TO PARTICIPATE IN PROGRAMMES SUCH AS ONE AT THE FAMOUS PIRELLI TESTING TRACK. ANOTHER INVOLVED SEVERAL DAYS TESTING FERRARI AND SEVERAL OTHER

IT WAS DURING THIS TIME THAT HE MET PAMMY, AN AUSTRALIAN GIRL TOURING THE UK AND EUROPE. ALLAN AND PAM WILL CELEBRATE 50 YEARS MARRIAGE LATER THIS YEAR, HAVING MARRIED ON 28 OCTOBER, 1967 AT CAXTON HALL REGISTRY IN WESTMINSTER. THE ENGLISH CHURCH WOULDN'T MARRY THE COUPLE BECAUSE ALLAN HAD BEEN MARRIED BEFORE, SOMETHING THAT DID UPSET HIS SERENITY! PAMMY AND ALLAN LIVED AT EAST GRINSTEAD IN THE COUNTY OF SUSSEX WHERE THEIR SON BARNABY WAS BORN IN 1971. SOON AFTER THEY MADE THE DECISION TO RETURN TO AUSTRALIA WITH THEIR DUAL-CITIZEN SON, FOLLOWING A SERIES OF BAD WINTER SEASONS FOR THE SUN-LOVING COUPLE.

ARRIVING BACK IN AUSTRALIA ALLAN FOUND IT HARD TO FIND A SUITABLE JOB BUT EVENTUALLY WAS APPOINTED ASSISTANT MANAGER WITH THE QUEENSLAND RETAIL TRADERS ASSOCIATION. THERE HIS TASK WAS TO HELP SET UP A NEW DIVISION FOR HARDWARE AND BUILDING MATERIALS RETAILERS. THIS WAS SO SUCCESSFUL THAT IT WAS SOON ADOPTED BY OTHER STATES. A BRISBANE BASED HARDWARE STAFF TRAINING SCHOOL WAS ESTABLISHED AT THE OLD WOOL STORES. THE TRAINING SCHOOL PRODUCED A LIBRARY OF EDUCATIONAL BOOKS AND MANUALS UNDER HIS GUIDANCE.

THESE ROLES TOOK ALLAN FROM 1972 THROUGH TO 1992 WHEN, AGED SIXTY FIVE HE OFFICIALLY RETIRED. MOVING FROM BRISBANE TO THE SUNSHINE COAST, HE AND PAMMY PURCHASED A SMALL AVOCADO ORCHARD ON UPPER ROSEMOUNT ROAD, NAMBOUR. THAT WAS THE HEATON HOME FOR THE NEXT SEVERAL YEARS DURING WHICH THEY UNDERTOOK A SERIES OF LONG DISTANCE CARAVAN 'EXPEDITIONS', ONE OF WHICH LASTED NINE MONTHS, ACROSS MUCH OF AUSTRALIA... AND SOME OF IT'S MOST NOTORIOUS ROADS AND TRACKS.

IN 1995 ALLAN AND PAM MOVED TO TOOWOOMBA. ALLAN JOINED A LOCAL WOODWORKING CLUB. AS HE DESCRIBES IT, HE WAS A NOVICE AMONG A LARGE NUMBER OF SPECIALISTS... TIMBER PEOPLE AND WOODWORKING SPECIALISTS. HE TOOK UP MAKING A RANGE OF TRADITIONAL STYLE JEWELLERY BOXES. HE TOOK A LIKING TO THE CRAFT.

BUT, DESPITE THEIR DELIGHT WITH LIVING IN TOOWOOMBA, MAROOCHYDORE STILL CALLED THEM AND THEY DECIDED TO MOVE BACK TO THE SUNSHINE COAST. HOUSE PRICES IN TOOWOOMBA FELL AND WITH THEIR REDUCED BUDGET THEY OPTED FOR A THREE-BED DUPLEX AT PALMWOODS WHERE THEY HAVE RESIDED VERY CONTENTEDLY EVER SINCE. THE TWO- CAR GARAGE WAS SPLIT AND ALLAN HAD HIMSELF A NEW WOODWORKER'S WORKSHOP.

WITH A NUMBER OF FRIENDS FROM ALLAN'S PAST BUSINESS DAYS LIVING AT MALENY HE WAS SOON VISITING THE ANNUAL MALENY WOOD SHOW AND AN INTRODUCTION TO THE AREA'S WOODWORKERS CLUB. AND THAT INTEREST CONTINUED ON WITH A VISIT TO THE BLACKALL RANGE WOODWORKERS GUILD AT MONTVILLE, AND THUS BEGAN HIS ASSOCIATION WITH THE WOODIES WHICH CONTINUES TO THIS DAY.



Allan with his collection of bandsaw boxes (one of which is still missing from the Club Competition; have you checked yours ?)

## Who's Who in BRWG Inc. 2017 - 18

Patrons - Andrew Powell MP, Mark Jamieson - Mayor SCRC and Cr Jenny McKay

President	John Muller	0418 871 946
Vice President	Greg McCosker	0418 746 420
Secretary	Graham Beaumont	0449 081 092
Asst. Secretary	Dave Edmond	5478 6932
Treasurer	Brian Harris	5445 7921
Asst. Treasurer	Lindsay Thomas, Julie Breen	
Newsletter Editors	Greg McCosker, Max Barrenger	
Website Editor	Dave Edmond	5478 6932
Publicity Officer	John Andrews, Hamish Borthwick	
Recruitment Officers	Dave Banister, Tom Black, Dave Edmond, Keith Muirhead	
Activity Officers	John Drew, John Clarke, Warne Wilson, Dave Banister, Keith Muirhead, Brian Harris, Max Barrenger	
Safety Officers	Dave Banister, Warne Wilson	
First Aid Officer	John Drewe	
Events Organiser	Rick Vickers	0408 663 842
Shed Managers	Greg McCosker, Terry O'Connor	
Amenity Officer	Hamish Borthwick	
Purchasing Officer	Rob Otto	
Training Officer	Rob Otto	
Librarian	Max Barrenger	
Timber Management	Ron Donald, Bob Rothwell. Bruce Chapman	



Monday	General Activities
Tuesday	Turning & Carving
Wednesday	General Workshop & Toys
Thursday	Furniture & Joinery
Friday	General Activities
Saturday	General Act. & Demo's